

Troubleshooting Internal PCs in Enhanced Classrooms:

- 1) Nothing is projecting
 - a. In the touch screen, make sure projector “on” is selected
 - b. Select a different input (ex. DVD), then reselect PC.
 - c. Make sure “Image On/Off” is turned off.
 - d. Turn Projector off, and then back on.
 - e. Turn off the System. After about 90 seconds, you can turn the projector back on again.

- 2) No Sound
 - a. Make sure the volume is turned up on the touch screen and computer.
 - b. Make sure mute isn’t selected on the touch screen or computer.
 - c. Select a different input (ex. DVD), then reselect PC.

Troubleshooting Laptops in Classrooms:

- 1) Nothing is projecting from laptop
 - a. Make sure display is duplicated.

- i. For Windows:

1. Press and hold the Windows and P keys. Cycle through until you find “Duplicate” as the display option.
 2. If that doesn’t work, unplug and re-plug VGA or HDMI cable



- ii. For Mac

1. Open the display preferences from within the Displays menu in system preferences.
 2. In the “Arrangement” tab, make sure the “Mirror Displays” check box is clicked.
 3. If that doesn’t work, check adapter cable on both ends. Unplug and re-plug it.
- b. If this does not work, switch to a different input (ex. DVD), then reselect your desired laptop input.
- c. Restart projector.
- d. Restart computer.

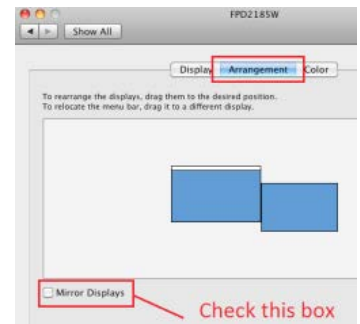

- 2) No Sound
 - a. Make sure the volume is turned up on the touch panel, wall plate, the remote, or the TV.
 - b. Make sure mute isn’t selected.
 - c. Select a different input (ex. DVD) then reselect your desired laptop input.